

NEW 12x12 VCT
TILE FLOORING

FINISH WALL END W/ NEW
G.W.B. TO MATCH EXISTING.

Diagram illustrating a kitchen cabinet layout. The layout includes a base labeled "NEW VINYL BASE" and a wall-mounted section. The wall-mounted section consists of a large upper cabinet and a smaller lower cabinet. The lower cabinet is divided into two sections: a left section with a single door and a right section with two doors. The left section of the lower cabinet is shaded with diagonal lines. The right section of the lower cabinet is divided into two sections: a top section with a single door and a bottom section with two doors. The bottom section of the lower cabinet is shaded with diagonal lines. The top section of the lower cabinet is divided into two sections: a left section with a single door and a right section with two doors. The right section of the top section of the lower cabinet is shaded with diagonal lines. The top section of the lower cabinet is divided into two sections: a left section with a single door and a right section with two doors. The right section of the top section of the lower cabinet is shaded with diagonal lines.

Diagram illustrating the layout and dimensions of a kitchen cabinet section. The layout includes upper and lower cabinets, a countertop, and a sink area. Dimensions are provided for the overall height and width of the section.

Dimensions:

- Overall Height: 7'-8"
- Overall Width: 2'-4"
- Countertop Height: 1'-7"
- Lower Cabinet Height: 2'-8"

Labels:

- EXISTING SOFFIT TO REMAIN
- NEW VINYL BASE

A detailed floor plan of a kitchen. The plan shows a rectangular layout with a sink and stove on the top wall, a refrigerator on the right wall, and a doorway on the left wall. A large area in the center of the kitchen is marked with a diamond-shaped tile pattern. This area is labeled with the number '4' on the left, '5' on the top, and 'A-100' in the center. An arrow points to this area with the text 'NEW 12x12 VCT TILE FLOORING'. Another diamond-shaped tile area is shown in the bottom right corner, labeled with the number '5'.

Floor plan diagram of a kitchen showing a U-shaped layout. The layout includes a sink area with a faucet, a stove, and a refrigerator. Dimensions are provided for the countertop and overall layout:

- Countertop depth: 2'-6"
- Countertop width (top section): 1'-3"
- Countertop width (bottom section): 3'-0"
- Overall width: 7'-8"
- Overall depth: 1'-3"

The diagram also shows a "NEW VINYL BASE" for the lower cabinets.

EXISTING SOFFIT TO REMAIN

EXISTING

NEW VINYL BASE

The kitchen area includes a refrigerator on the left, upper and lower cabinets on the right, and a hatched area representing a wall or island.

EXISTING SOFFIT TO REMAIN

NEW VINYL BASE

2'-6"

1'-7"

2'-8"

7'-6"

EXIST.

The diagram shows a kitchen island layout. The top section is labeled 'EXISTING SOFFIT TO REMAIN' and includes a sink, a cooktop, and various cabinet units. The bottom section is labeled 'NEW VINYL BASE' and includes a long, narrow base unit. Dimensions are indicated on the right side: 2'-6" for the existing soffit, 1'-7" for the new vinyl base, and 2'-8" for the total height. A total width dimension of 7'-6" is also shown on the right. The island is connected to the main kitchen area by a narrow passage.

EXISTING SOFFIT TO REMAIN

NEW VINYL BASE

A-100



- DRAWINGS ARE NOT TO BE SCALED FOR INFORMATION. USE WRITTEN DIMENSIONS FOR ALL MEASUREMENTS. UNLESS NOTED OTHERWISE, ALL DIMENSIONS ARE TAKEN FROM ROUGH FRAMING FACE. VERIFICATION OF ACTUAL CONDITIONS TO BE CONFIRMED BY CONTRACTOR.



SEAL & SIGNATURE	DATE: April 24, 2011
	DRAWN BY: MSE
	CHK. BY: MSE
	DWG. NO.:

The floor plan shows a building layout with 14 numbered rooms and a central common space. The rooms are arranged as follows:

- Room #1:** Located at the bottom left, containing a desk, chair, and a small kitchen area.
- Room #2:** Located at the top left, containing a desk, chair, and a small kitchen area.
- Room #3:** Located at the bottom left, containing a desk, chair, and a small kitchen area.
- Room #4:** Located at the bottom center, containing a desk, chair, and a small kitchen area.
- Room #5:** Located at the top center, containing a desk, chair, and a small kitchen area.
- Room #6:** Located at the bottom center, containing a desk, chair, and a small kitchen area.
- Room #7:** Located at the top center, containing a desk, chair, and a small kitchen area.
- Room #8:** Located at the bottom center, containing a desk, chair, and a small kitchen area.
- Room #9:** Located at the bottom right, containing a desk, chair, and a small kitchen area.
- Room #10:** Located at the top right, containing a desk, chair, and a small kitchen area.
- Room #11:** Located at the bottom right, containing a desk, chair, and a small kitchen area.
- Room #12:** Located at the top right, containing a desk, chair, and a small kitchen area.
- Room #13:** Located at the bottom right, containing a desk, chair, and a small kitchen area.
- Room #14:** Located at the top right, containing a desk, chair, and a small kitchen area.
- COMMON SPACE:** A large open area located in the center of the building, containing a desk, chair, and a small kitchen area.

BUILDING "A" KEY PLAN
SCALE: N.T.S.

The floor plan of the 1st floor shows a series of rooms arranged in a long, narrow layout. Rooms are numbered #15 through #28. The plan includes detailed room layouts, furniture, and stairs. The rooms are arranged in a sequence, with some rooms having multiple entrances and exits. The layout is as follows:

- Room #15: Located at the bottom left, containing a desk, chair, and a small table.
- Room #16: Located above #15, containing a desk, chair, and a small table.
- Room #17: Located to the right of #15, containing a desk, chair, and a small table.
- Room #18: Located to the right of #16, containing a desk, chair, and a small table.
- Room #19: Located to the right of #18, containing a desk, chair, and a small table.
- Room #20: Located to the right of #19, containing a desk, chair, and a small table.
- Room #21: Located to the right of #20, containing a desk, chair, and a small table.
- Room #22: Located to the right of #21, containing a desk, chair, and a small table.
- Room #23: Located to the right of #22, containing a desk, chair, and a small table.
- Room #24: Located to the right of #23, containing a desk, chair, and a small table.
- Room #25: Located to the right of #24, containing a desk, chair, and a small table.
- Room #26: Located to the right of #25, containing a desk, chair, and a small table.
- Room #27: Located to the right of #26, containing a desk, chair, and a small table.
- Room #28: Located to the right of #27, containing a desk, chair, and a small table.

BUILDING "B" KEY PLAN
SCALE: N.T.S.

The floor plan of the 1st floor shows 14 numbered rooms arranged in two main sections. The top section contains rooms #30 through #45, and the bottom section contains rooms #32 through #47. Each room is depicted with its internal layout, including desks, chairs, and other furniture. Stairwells are indicated by sets of stairs within the room layouts. The rooms are interconnected by a network of corridors and doorways.

BUILDING "C" KEY PLAN
SCALE: N.T.S.

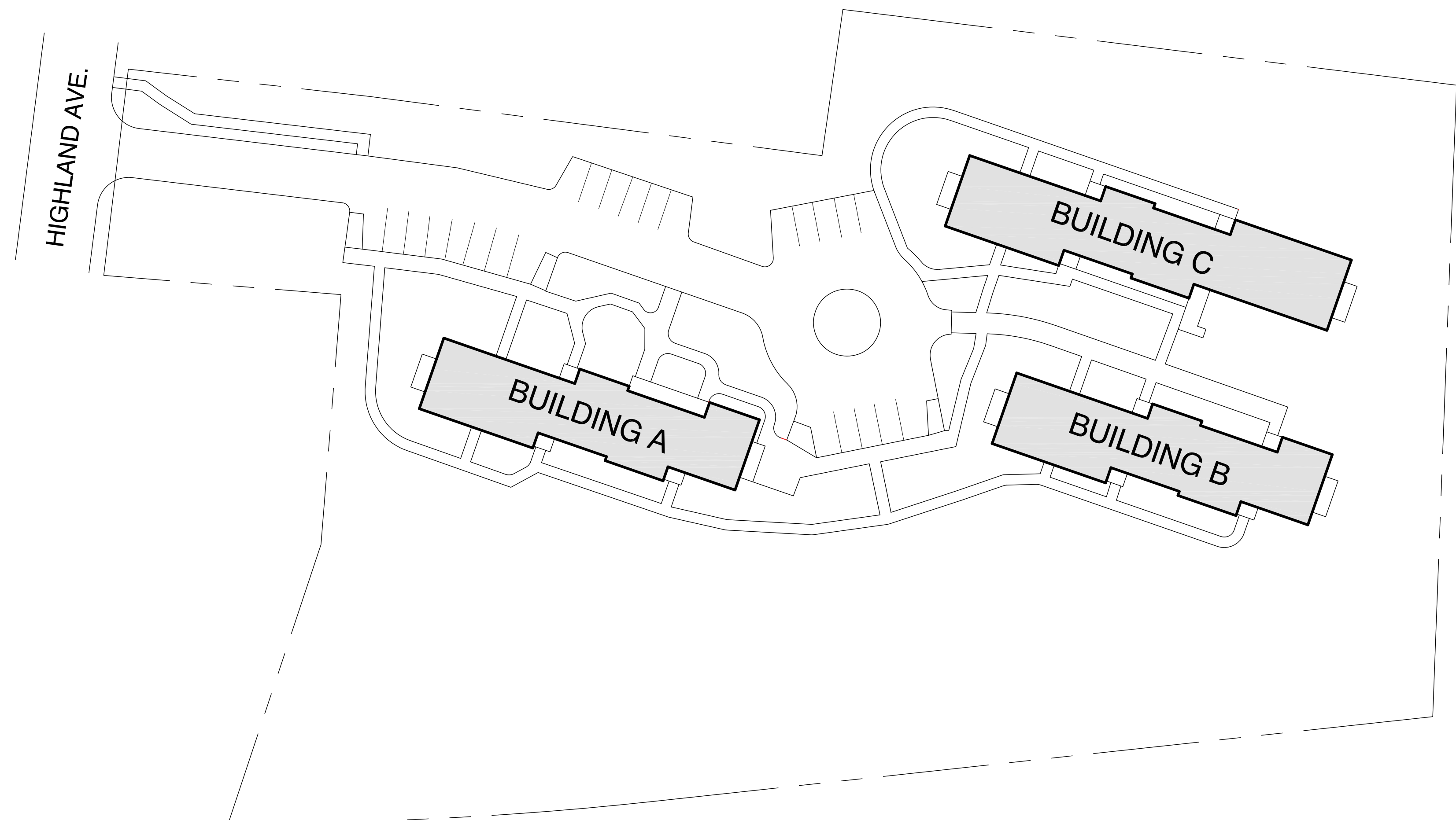

1 **Site Plan**
SCALE: N.T.S.

ARCHITECTS INC.

BRADLEY
EST. 1896

8 Bank Row, Pittsfield, MA 01201 | 413-448-8253 |
BradleyArchitectsInc.com

CONSULTANTS

[illegible]